

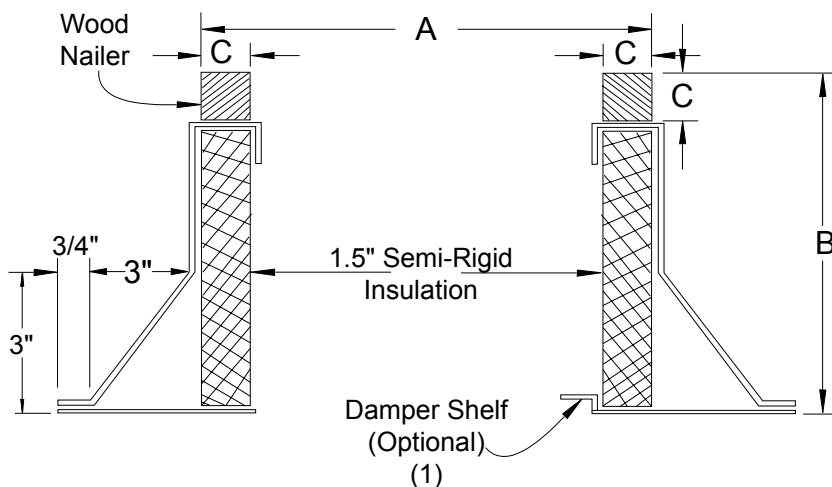

P: 866.733.0233  
www.solerpalaucanada.com

# INSULATED CANTED ROOF CURB NON-PROPELLER PRODUCTS



**OPTIONS:**

1. Damper Shelf.
2. Metal Liner - solid or screen type.
3. Burglar bars - 1/2" dia. on 6" centers.
4. Finishes - baked or air-dried enamel or epoxy.
5. Heights: 8, 12, 16, 18, 20, 24" or special heights.
6. Single pitch or double pitch.
7. Aluminum construction.
8. Standard curb is "RF" roof over type.  
("SF" available upon request)

| FAN SIZE | "A" OD (Square) CURB |        |        |           | DB       |             | "B" CURB HEIGHT | "C" WOOD NAILER |
|----------|----------------------|--------|--------|-----------|----------|-------------|-----------------|-----------------|
|          | TXB                  | TXD    | RCXII  | RED / LPD | FAN SIZE | CURB OD "A" |                 |                 |
| 6        | -                    | 14-3/4 | 14-3/4 | 14-3/4    | 6        | 14-3/4      | 12" STD         | 1-1/2" Sq       |
| 8        | 14-3/4               | 14-3/4 | 14-3/4 | 14-3/4    | 8        | 14-3/4      |                 |                 |
| 10       | 14-3/4               | 14-3/4 | 22-1/4 | 14-3/4    | 9        | 14-3/4      |                 |                 |
| 12       | 22-1/4               | 22-1/4 | 22-1/4 | 22-1/4    | 11       | 22-1/4      |                 |                 |
| 14       |                      |        | 22-1/4 |           |          |             |                 |                 |
| 15       | 22-1/4               | 22-1/4 | -      | 22-1/4    | 12       | 22-1/4      |                 |                 |
| 16       |                      |        | 22-1/4 |           |          |             |                 |                 |
| 18       | 27-3/4               | -      | 27-3/4 | -         | 14       | 22-1/4      |                 |                 |
| 20       | -                    | -      | 27-3/4 | -         | 16       | 22-1/4      |                 |                 |
| 24       | 33-3/4               | -      | 33-3/4 | -         | 18       | 27-3/4      |                 |                 |
| 26       | -                    | -      | 33-3/4 | -         | 20       | 27-3/4      |                 |                 |
| 30       | 40-3/4               | -      | 40-3/4 | -         | 24       | 33-3/4      |                 |                 |
| 33       | -                    | -      | 40-3/4 | -         | 30       | 40-3/4      |                 |                 |
| 36       | 40-3/4               | -      | 40-3/4 | -         | 36       | 40-3/4      |                 |                 |
| 42       | 53-1/4               | -      | -      | -         | 42       | 53-1/4      |                 |                 |
| 48       | 53-1/4               | -      | -      | -         | 48       | 53-1/4      |                 |                 |

1. Damper shelf opening to be 1" less than damper size. Shelf must be specified if required.
2. All curbs are 18 gauge G-90 galvanized steel with continuous seams.
3. See current curb submittal for all propeller fan roof curbs.

**ROOF OPENING**  
Curb O.D. (A Dimension) Less 3.25 inches

| ACCESSORY ITEMS          | 1 | 2 | 3 | 4 | 5 | ACCESSORY ITEMS          | 1 | 2 | 3 | 4 | 5 |
|--------------------------|---|---|---|---|---|--------------------------|---|---|---|---|---|
| <input type="checkbox"/> |   |   |   |   |   | <input type="checkbox"/> |   |   |   |   |   |
| <input type="checkbox"/> |   |   |   |   |   | <input type="checkbox"/> |   |   |   |   |   |
| <input type="checkbox"/> |   |   |   |   |   | <input type="checkbox"/> |   |   |   |   |   |
| <input type="checkbox"/> |   |   |   |   |   | <input type="checkbox"/> |   |   |   |   |   |

Project: \_\_\_\_\_ Submitted: \_\_\_\_\_  
 Customer: \_\_\_\_\_ Approved: \_\_\_\_\_  
 Location: \_\_\_\_\_



P: 866.733.0233  
www.solerpalaucanada.com

# BACKDRAFT DAMPER FOR ROOF MOUNTED AND INLINE CENTRIFUGAL/PROPELLER EXHAUST FANS

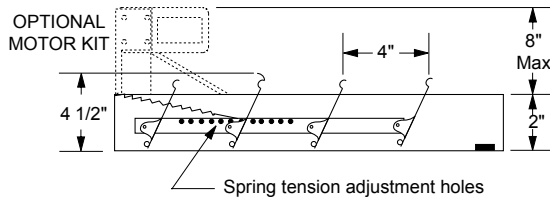

AIR FLOW ↑

For low velocity (CFM) field adjustment of spring tension may be required to ensure that damper blades open completely.

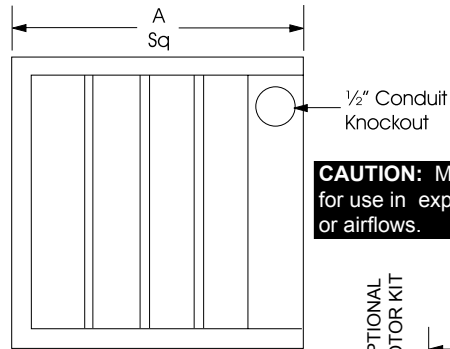

**CAUTION:** Motor kits are not suitable for use in explosive or flammable areas or airflows.

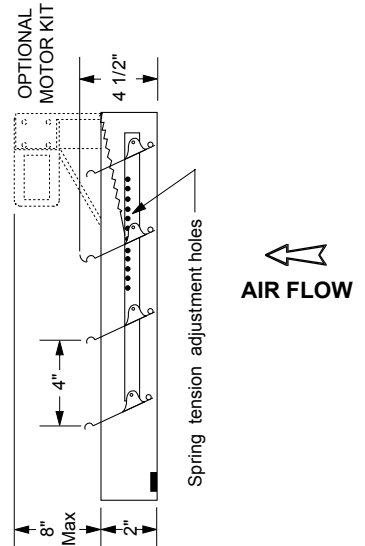

AIR FLOW ←

| FAN SIZE | CENTRIFUGAL ROOF FANS  | INLINE FANS |            | PROPELLER  |
|----------|------------------------|-------------|------------|------------|
|          | DB, RED, TXB, LPD, TXD | SQB         | SQD        | ARE        |
|          | "A" SQUARE             | "A" SQUARE  | "A" SQUARE | "A" SQUARE |
| 6        | 11                     | -           | 9          | -          |
| 7        | -                      | 12          | -          | -          |
| 8        | 11                     | 12          | 12         | -          |
| 9        | 11                     | -           | -          | -          |
| 10       | 11                     | 14          | 14         | 14         |
| 11/12    | 18                     | 18          | 18         | 18         |
| 14       | 18                     | -           | -          | -          |
| 15       | 18                     | 22          | 20         | -          |
| 16       | 18                     | -           | -          | 22         |
| 18       | 24                     | 24          | -          | -          |
| 20       | 24                     | 28          | -          | 26         |
| 24       | 30                     | 35          | -          | -          |
| 30       | 36                     | 40          | -          | -          |
| 36       | 36                     | 48          | -          | -          |
| 42       | 48                     | 54          | -          | -          |
| 48       | 48                     | -           | -          | -          |

**STANDARD SPECIFICATIONS:**

Maximum Face Velocity: 2250 fpm.  
Dimensions: See sizing chart  
"A" Dimension is square damper size.  
Frame: Galvanized steel, 2" Deep  
Blades: 26 gauge Mill Finish aluminum.  
Blade pivots: Stainless steel rivet at all pivot points.  
Seals: Felt between adjacent blades.  
Counter Balance: Adjustable spring tension.  
Finish: Mill.  
Max Temp: Damper 250° F  
Motor 130° F

**CAUTION:** Motor kits are not suitable for use in explosive or flammable areas or airflows.

**NOTES:**

- Units are undersized 1/4" to fit in square ducts.
- Do not mount fan less than 1/3 diameter of the fan from the damper.
- Dampers shipped in individual cartons.
- Motor kits ship loose for field installation.

| ACCESSORY ITEMS          | 1 | 2 | 3 | 4 | 5 | ACCESSORY ITEMS          | 1 | 2 | 3 | 4 | 5 |
|--------------------------|---|---|---|---|---|--------------------------|---|---|---|---|---|
| <input type="checkbox"/> |   |   |   |   |   | <input type="checkbox"/> |   |   |   |   |   |
| <input type="checkbox"/> |   |   |   |   |   | <input type="checkbox"/> |   |   |   |   |   |
| <input type="checkbox"/> |   |   |   |   |   | <input type="checkbox"/> |   |   |   |   |   |
| <input type="checkbox"/> |   |   |   |   |   | <input type="checkbox"/> |   |   |   |   |   |

Project: \_\_\_\_\_ Submitted: \_\_\_\_\_  
Customer: \_\_\_\_\_ Approved: \_\_\_\_\_  
Location: \_\_\_\_\_